

DUTCH HILL ROAD TIMBER BRIDGE, Crawford County , Pennsylvania

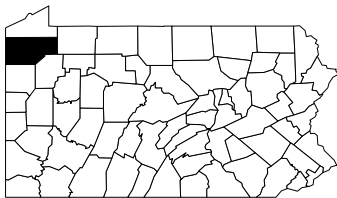

Type: Stress-laminated deck
County: Crawford
Owner: City of Titusville
Built in: 1992
Engineer: Northwest Engineering, Inc.
Spans over: Hammond Run Creek
Bridge length: 26'-0 1/2"
Roadway width: 28'-0"

Directions: From Titusville, south on PA 8, .5 miles to the intersection of PA 8 and Dutch Hill Road. Left turn onto Dutch Hill Road. The bridge site is 200 feet from the intersection of Dutch Hill Road and PA 8.

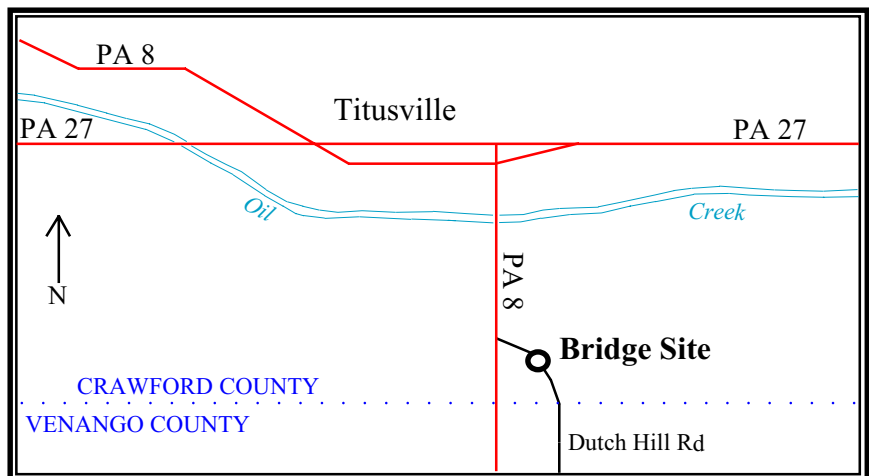

GEOMETRY

Number of Spans: 1	Design load: AASHTO HS-25 and ML-80	Total wood quantity: 13,200 bf
Out-to-out length: 26'-0 1/2"	Design by: Northwest Engineering, Inc.	Total steel quantity: 2324 lbs
Center-of-bearing length: 24'-0"	Abutment material: Timber pile	
Skew: 15 degrees		
Number of lanes: 2		
Out-to-out width: 30'-0"		
Curb-to-curb width: 28'-0"		
Superstructure square footage: 780		

MATERIAL**DECK**

Material: Wood
 Grade: Structural no. 1 or better
 Species: Red maple*
 Sizes used: 2" x 15"
 Quantity: 11,700 bf
 Preservative treatment: Creosote
 Specification: AWWPA C1-84
 *White oak fascia boards

BEAMS/STRINGERS (none)**GUIDERAIL POSTS**

Material: Wood
 Grade: Structural no. 2 or better
 Sizes used: 10" x 12"
 Quantity: 375 bf
 Preservative treatment: Creosote
 Specification: AWWPA C1-84

GUIDERAIL CURB

Material: Wood
 Grade: Structural no. 2 or better
 Size: 6" x 12"
 Quantity: 325 bf
 Preservative Treatment: Creosote

GUIDERAIL

Material: Wood
 Grade: Structural no. 2 or better
 Size: (2) 8" x 8"
 Quantity: 800 bf
 Preservative treatment: Creosote

STRESSING STEEL

Grade: ASTM A722
 Bar Diameter: 1"
 Coating: Galvanized
 Quantity: 2324 lbs
 Bearing plate size: 12" x 14" x 1"

FUNDING SOURCES: USDA Forest Service: \$7,000; Balance of funding from the Pennsylvania Department of Transportation local funds.

LOCAL CONTACT: City Manager
 City of Titusville
 107 North Franklin St.
 Titusville, PA 16354
 Phone: 814-827-5302

Information provided by The Pennsylvania Department of Transportation and derived from plans for Dutch Hill Road bridge crossing Hammond Run Creek.

WIT Program Proposal Number: NA-24-89

Federal Grant Identifier: NA-89-0224

December 1999



Northeastern Area
 State and Private Forestry

The National Wood In
 Transportation Program

